

This document is the property of Amphenol Corporation and is delivered on the express condition that it is not to be disclosed, reproduced or used in whole or in part, for manufacture or sale by anyone other than Amphenol Corporation without its prior consent, & that no right is granted to disclose or to use any information in this document.

REVISIONS				
SWM	ECN	DESCRIPTION	DATE	APPROVED
A		INITIAL RELEASE	03/04/05	C LOKE

Table 1

NO. OF POSITION	DIMENSION		
	A	B	C
08	1.50	3.30	4.70
10	2.00	3.80	5.20
12	2.50	4.30	5.70
14	3.00	4.80	6.20
16	3.50	5.30	6.70
18	4.00	5.80	7.20
20	4.50	6.30	7.70
22	5.00	6.80	8.20
24	5.50	7.30	8.70
26	6.00	7.80	9.20
28	6.50	8.30	9.70
30	7.00	8.80	10.20
32	7.50	9.30	10.70
34	8.00	9.80	11.20
36	8.50	10.30	11.70
38	9.00	10.80	12.20
40	9.50	11.30	12.70
42	10.00	11.80	13.20
44	10.50	12.30	13.70
46	11.00	12.80	14.20
48	11.50	13.30	14.70
50	12.00	13.80	15.20

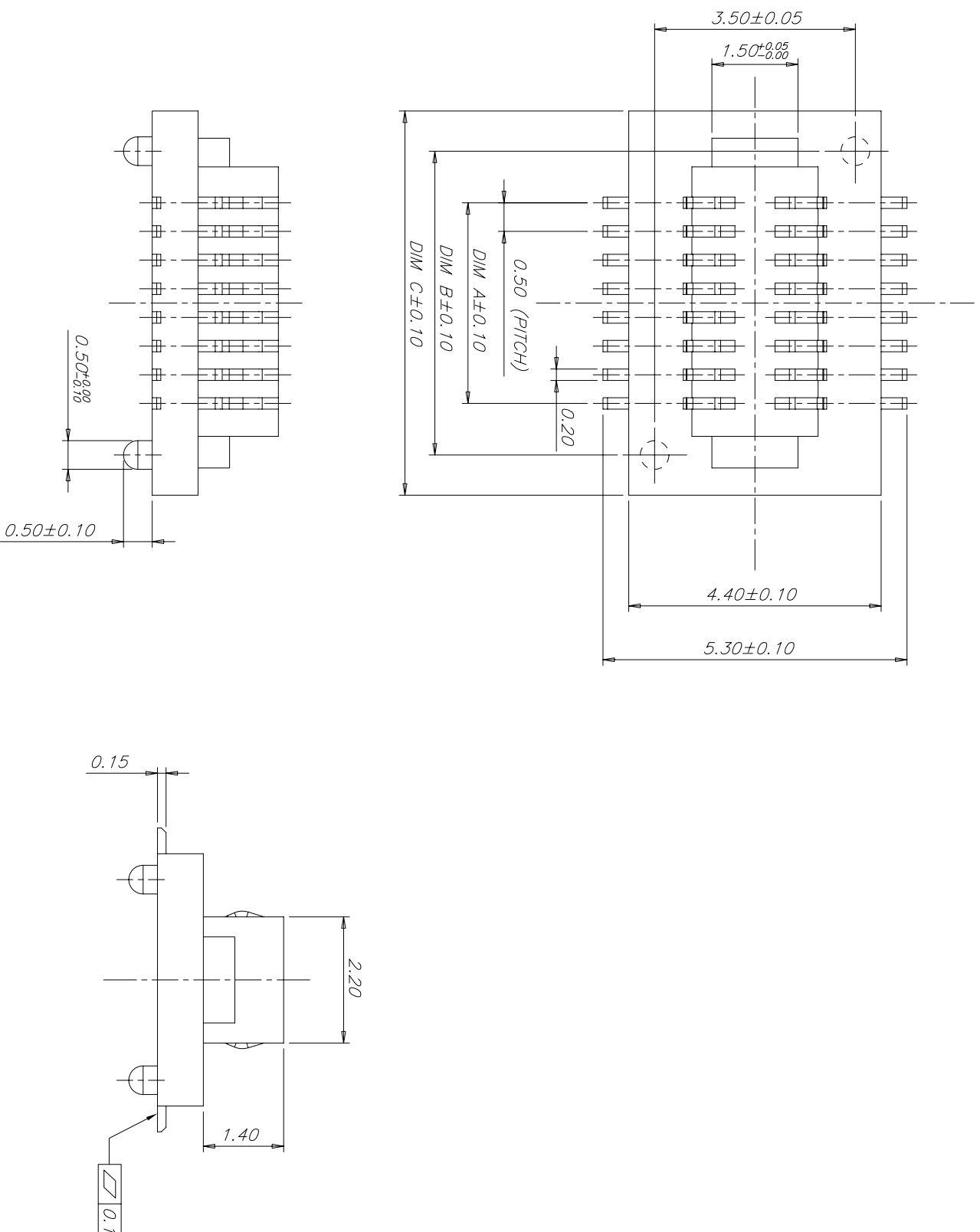

CUSTOMER DRAWING

UNLESS OTHERWISE SPECIFIED TOLERANCES		APPROVAL		DATE		TITLE BTB CONNECTOR (PLUG, 0.5MM PITCH)
U.S.	METRIC	DRAWN	V SOH	03/04/05	03/04/05	
X +/-	0.30	CHECKED <td>C LOKE <td>03/04/05 <td></td> </td></td>	C LOKE <td>03/04/05 <td></td> </td>	03/04/05 <td></td>		
.XX +/-	0.20	DRAWING FILE :				
.XXX +/-	0.05	ANGLE OF PROJECTION				
ANGLES +/-	1°	REMOVE SHARP EDGES				
FOR MATERIALS AND FINISHES SEE NOTES		DIMENSIONS				SIZE A3
REMOVE SHARP EDGES		DIMS				DRAWING NO. SBB-XX05-1XX1
DIMENSIONS		SCALE				REV. A
U.S. INCHES		NONE				SHEET 1 OF 2
(METRIC) (MM)						

This document is the property of Amphenol Corporation and is delivered on the express condition that it is not to be reproduced, copied, or used in whole or in part, for manufacture or sale by anyone other than Amphenol Corporation without its prior consent, & that no right is granted to disclose or to use any information in this document.

REVISIONS				
SYM	ECN	DESCRIPTION	DATE	APPROVED
A		INITIAL RELEASE	03/04/05	C LOKE

Ordering Information

SBB - XX 05 - 1 YY 1

BTB Series

Stacking Height

See Table 2

No of Pins

See Table 1

eg. 8 pos: 08

32 pos: 32

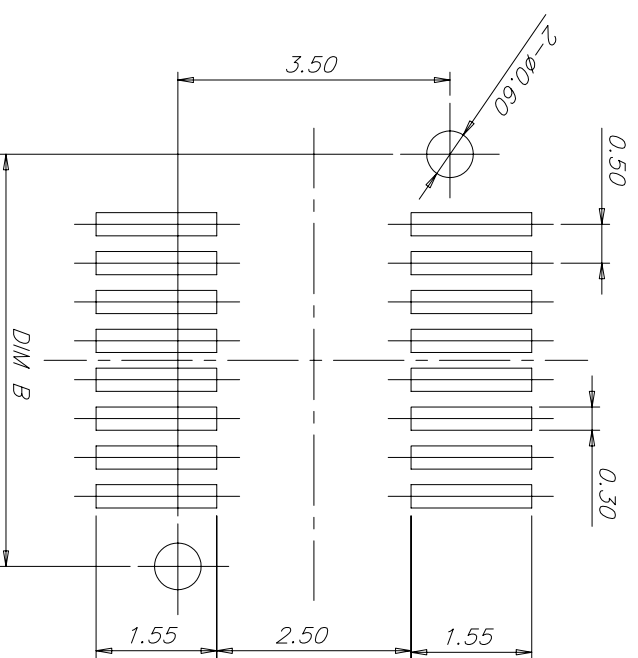

RECOMMENDED PCB LAYOUT

(GENERAL TOL: ±0.05)

Table 2

Stacking Height	XX
2.5mm	25
3.0mm	30
3.5mm	35
4.0mm	40
4.5mm	45
5.0mm	50

NOTE

1. MATERIAL and PLATING

- 1) HOUSING : THERMOPLASTIC(UL94V-0), BLACK
- 2) CONTACT TERMINAL : COPPER ALLOY
- 3) PLATING : Au FLASH OVER Nickel 1.27um min

2. INSULATION RESISTANCE : 1000 MΩ min

3. TEMPERATURE RANGE : -55°C ~ +85°C

4. CONTACT RESISTANCE(INITIAL VALUE) : 60mΩ max

CUSTOMER DRAWING

UNLESS OTHERWISE SPECIFIED

TOLERANCES U.S. METRIC

X	+/-	0.30
.XX	+/-	0.20
.XXX	+/-	0.05
FRACTIONS +/-		
ANGLES +/-		1°

FOR MATERIALS AND FINISHES SEE NOTES

REMOVE SHARP EDGES

DIMENSIONS

U.S.	INCHES
(METRIC)	(MM)

APPROVAL DATE

DRAWN	V SOH	03/04/05
CHECKED	C LOKE	03/04/05

DRAWING FILE :

ANGLE OF PROJECTION

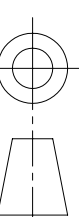

Amphenol

BTB CONNECTOR
(PLUG, 0.5MM PITCH)

SIZE	DRAWING NO.	REV.
A3	SBB-XX05-1XX1	A
SCALE	NONE	SHEET 2 OF 2